

12/10 Female Slip-Ons

CMA Range 5180-13,100 Barrel Inside Diameter .129" / 3.27 mm

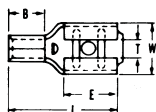

Material: BRASS **Thickness:** .018" / .457 mm

Basic Dimensions					Non-Insulated												
NEMA TAB	W In.	W mm	T In.	T mm	NIT	E In.	E mm	L In.	L mm	Hand Tool	H270 Die	NIT-IG	E In.	E mm	L In.	L mm	
.020 x.187	.233	5.92	.026	.660	SO9308 *	.250	6.35	.69	17.53	H4A							
.032 x.187	.233	5.92	.026	.660	SO9312 *	.250	6.35	.69	17.53	H4A							
.032 x.250	.300	7.62	.065	1.65	SO9300 *	.300	7.62	.72	17.53	H4A		SO9180	.300	7.62	.89	22.61	
.032 x.250	.300	7.62	.065	1.65	SO9176 • †	.300	7.62	.72	17.53	27058							

* UL Listed for 12 AWG only
 • Not UL listed † True Barrel - 1 pc part
 SO9300 = SO9076 & 1049 sleeve

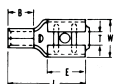

Basic Dimensions					Insulated (Yellow Vinyl)					Insulated (Yellow Nylon)						
NEMA TAB	W In.	W mm	T In.	T mm	Funnel FIT	Insul. Dia.	E In.	E mm	L In.	L mm	Hand Tool	Funnel FIIG	E In.	E mm	L In.	L mm
.020 x.187	.233	5.92	.026	.660	SO9309F	.265" / 6.73 mm	.250	6.35	1.00	25.40	H6E	XSO9310N †	.250	6.35	1.00	25.40
.032 x.187	.233	5.92	.026	.660	SO9313F	.265" / 6.73 mm	.250	6.35	1.00	25.40	H6E	XSO9314N †	.250	6.35	1.00	25.40
.032 x.250	.300	7.62	.065	1.65	SO9301F	.265" / 6.73 mm	.300	7.62	1.08	25.40	H6EC	XSO9302N †	.300	7.62	1.06	19.81
											Hand Tool	H6E				

UL Listed for 12 AWG Only

UL Listed for 12 AWG Only
† 4 pc part

22/18 • 16/14 • 12/10 Piggy Back Slip-Ons

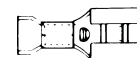
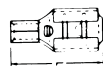
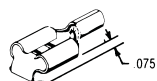

Material: BRASS **Thickness:** .016" / .406 mm

Basic Dimensions					Non-Insulated									
Insul. Color	I.D. In./mm.	CMA Range	Wire Range	NEMA Tab	NIT	L In.	Hand Tool	H270 Die	NIT-IG	L In.	Hand Tool	H270 Die		
Red	.061"/1.55	509-2050	22-18	.032 x.250	SO73159S	.76	H12	27132	SO73161S	.76	H12	27133		
Blue	.085"/2.16	2050-5180	16-14	.032 x.250	SO73170S	.76	H12	27135	SO73172S	.76	H12	27136		
Yellow	.129"/3.27	5180-13,100	12-10	.032 x .250	SO73181 *	.76	H4A		SO73183 *	.76		27139		

* UL Listed for 12 AWG Only * UL Listed for 12 AWG Only

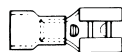

Basic Dimensions					Insulated (Vinyl)					Insulated (Nylon)				
Insul. Color	I.D. In./mm.	CMA Range	Wire Range	NEMA Tab	Funnel FIT	Ins. Dia.	L	Hand Tool	NIT-IG	Ins. Dia.	L	Hand Tool		
Red	.061"/1.55	509-2050	22-18	.032 x.250	SO73163SF	.125	.88	H13	XSO73165SN	.118	.88	H43		
Blue	.085"/2.16	2050-5180	16-14	.032 x.250	SO73174SF	.160	.88	H13	XSO73176SN	.146	.88	H43		
Yellow	.129"/3.27	5180-13,100	12-10	.032 x .250	SO73185F *	.265	1.01	H6E	XSO73187N *	.227	1.03	H6E		

* UL Listed for 12 AWG Only * UL Listed for 12 AWG Only

